



Compartment Inserts for Lima MBE

To remove the roof/window assembly apply light pressure to one of the four clips on one side of the window glazing while lifting the roof off, continue with the next clip and so on until the roof/window section comes out of the body.

The longer acrylic compartment piece contains four compartments, glue the dividers into the long face. The divider with the letter S has a step to clear the mouldings in the Lima MBE body. The divider with the letter T is located at the toilet end of the insert. The acrylic face has the doors cut out, these can be covered with the thin styrene sheet provided if the doors are to be closed, note also the small windows to the compartments are cut out. The spreader is glued onto the dividers to give rigidity to the assembled insert.

The same procedure applies to the smaller insert for the other end of the car, also with four compartments.

Once the inserts have been assembled they can be painted to simulate wood colour and glued in place in the car and the roof/window assembly re-installed.

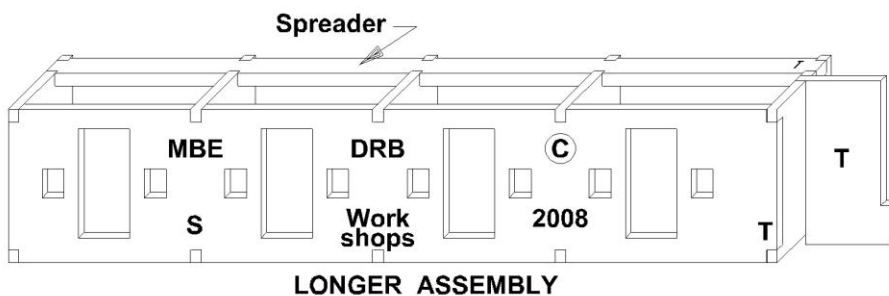

LONGER ASSEMBLY

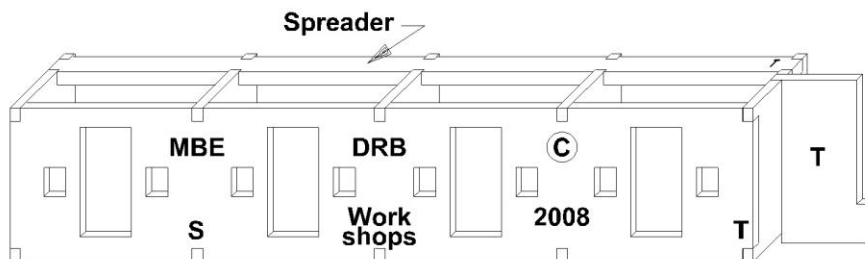

SHORT ASSEMBLY

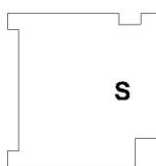

STEPPED
DIVIDER
2 off

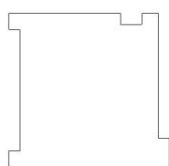

STANDARD
DIVIDER
6 off

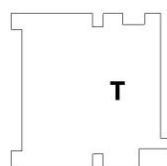

TOILET
DIVIDER
2 off



TOILET
WALL
2 off